

QLINE// Specifications

		GN-2046	GN-2646	GN-3246
	Working height*	8,3 m	10,1 m	12 m
A	Platform height	6,3 m	8,1 m	10 m
	Platform dimension (length x width)			
C D	- platform retracted	2,25 m x 1,15 m	2,25 m x 1,15 m	2,25 m x 1,15 m
B D	- platform extended	3,15 m x 1,15 m	3,15 m x 1,15 m	3,15 m x 1,15 m
E	Height - stowed	2,22 m	2,35 m	2,48 m
F	Height – retracted rails	1,6 m	1,73 m	1,86 m
G	Height – transport position (minimum height)	1,6 m	1,73 m	1,86 m
H	Length - stowed	2,39 m	2,39 m	2,39 m
K	Width	1,15 m	1,15 m	1,15 m
I J	Ground clearance (center/with pothole guards deployed)	10 / 2 cm	10 / 2 cm	10 / 2 cm
Productivity				
	Max platform occupancy (indoor / outdoor)	2/2	2/1	2/1
	Lift capacity	550 kg	450 kg	320 kg
	Drive speed - stowed	3,2 km/h	3,2 km/h	3,2 km/h
	Drive speed - raised	0,8 km/h	0,8 km/h	0,8 km/h
	Gradeability**	25%	25%	25%
	Turning radius - inside	zero	zero	zero
	Turning radius - outside	2,35 m	2,35 m	2,35 m
	Raised / lower speed	33-38 / 30-35 sec	33-38 / 35-40 sec	53-58 / 40-45 sec
	Controls	proportional	proportional	proportional
	Tyres – solid non-marking	380x125mm	380x125mm	380x125mm
Power				
	Power source	24V DC (4 standard acid batteries) 6V 240 Ah	24V DC (4 standard acid batteries) 6V 240 Ah	24V DC (4 standard acid batteries) 6V 240 Ah
	Hydraulic system capacity	20 L	21 L	34L
Sound and Vibration levels				
	Sound pressure level - ground	<70 dBA	<70 dBA	<70 dBA
	Sound Pressure level - platform	<70 dBA	<70 dBA	<70 dBA
	Vibration	<2,5 m/s ²	<2,5 m/s ²	<2,5 m/s ²
Weight***				
		2,070 kg	2,490 kg	2570 kg
CE – Standard Compliance		EC Directives: 2006/42/EC – machinery EN280:2013); Directives 2004/108/EC (EMC); Directives 2006/95/EC (LVD)		

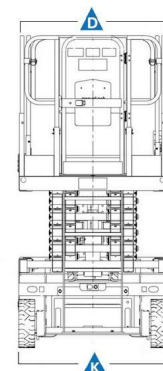
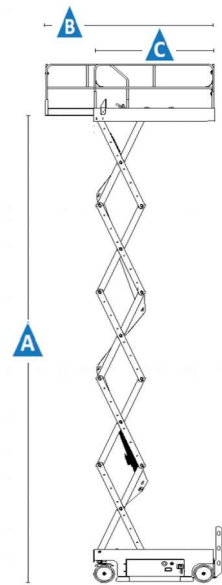
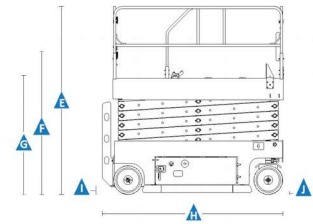

* the metric equivalent of working height adds 2m to platform height.
 ** gradeability applies on driving on slopes. See operator's manual for details regarding slope ratings
 *** weight will vary depending on options and/or country standards

LINE// Features

Standard Features

GN-2046

- 8,3 m – working height
- 550 kg – lift capacity

GN-2646

- 10,1 m – working height
- 450 kg – lift capacity

GN-3246

- 12,00 m – working height
- 320 kg – lift capacity

Productivity

- Electrostatic powder coating system
- Unical platform stability, construction is much more solid, platform extension smoothly operated
- Solid floor made of anti-slippery, riffled metal sheets
- Durable steel protection railings with openable gate
- Riffled-surface steps
- 1 working light mounted at the end of platform extantion deck (LED spotlight)
- Handles for crane lifting
- Hydraulic Drive motors protection
- Hydraulic hoses protection
- Machine prepared for either side or back forklift loading
- Side protection pads on the chassis and components swing-out trays
- Stable and solid swing-out electric and hydraulic components trays – key lockers
- Onboard electronic system DELTA 5, USA, possible calibration without PC
- Platform control joystick with battery charge indicator
- Fully proportional joystick for left or right handed users
- Emergency stop at both platform and ground controls
- Battery charging access point on the side of the machine
- 230 V electric line to platform with circuit breaker protection
- Manual platform lowering valve
- Back wheel hydraulic dynamic braking
- Manual hydraulic brake release
- Electronic horn
- Tilt level sensor with audible alarm
- Hour meter
- Certified load sensor
- Flashing LED beacons

Power

GN-2046 (GTJZ0612); GN-2646 (GTJZ0812); GN-3246 (GTJZ1012)

- 24 V DC – four 6V acid batteries - 240 Ah
- Universal 20 AMP smart charger

Drive

- Hydraulic, dual front wheel drive

Tyres

- Solid non-marking

Additional Options

- Airline to platform
- Biodegradable hydraulic oil
- Maintance free lithium battery, Gell battery or AGM battery option
- Individual painting colors selection on demand
- Parktronic System (parking sensors set).
- GPS with acces device
- EX explosion proof by ATEX

